



Pelican

**WOMEN'S
CHAMPIONSHIP**

May 11-17, 2020
Pelican Golf Club
Belleair, FL

Prepared for:
Belleair Ad Hoc Meeting
Wednesday, November 13th, 2019

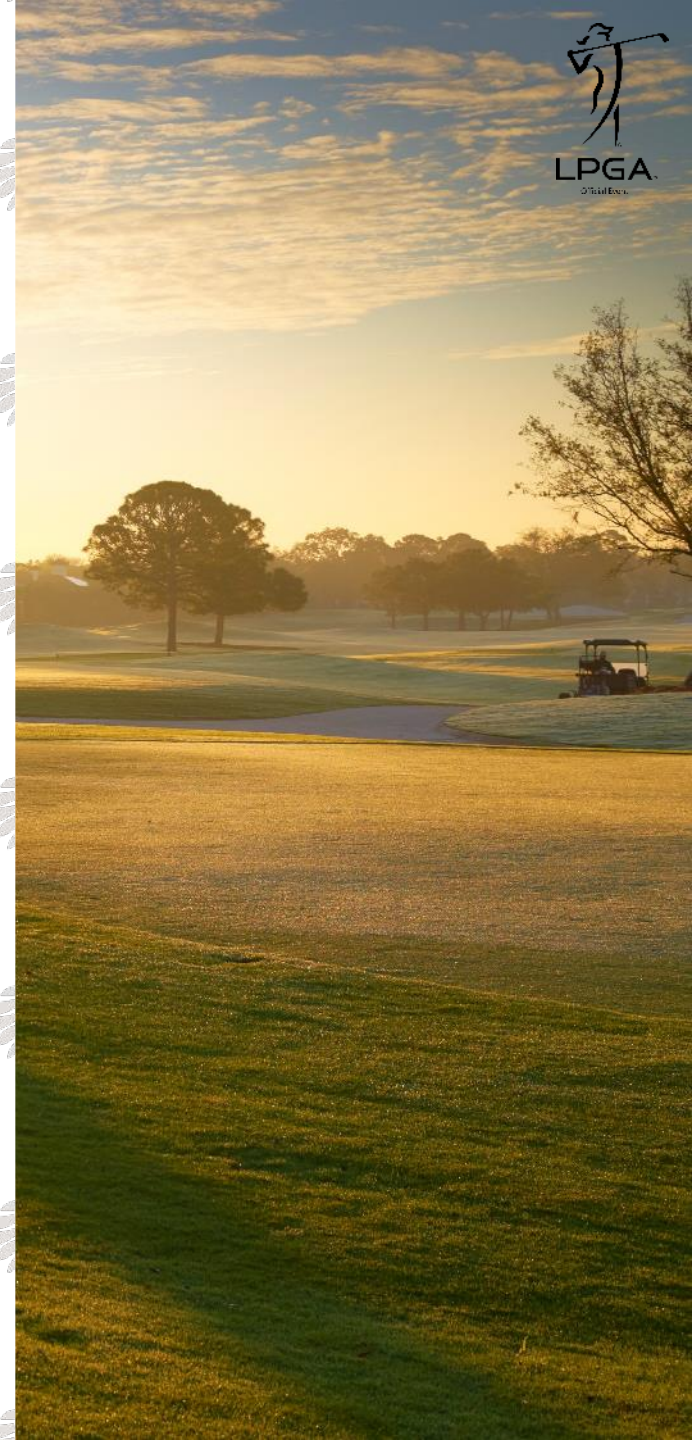

AGENDA



- **General Tournament Information**
 - Tournament Info
 - LPGA Tour
 - Schedule of Events
- **Operations**
 - Site Plan
 - Course Map
 - Entrance
 - 18th Green
 - Construction Schedule
 - Parking
 - Misc. Vendors
- **Volunteer Information**
 - General Information
 - Uniform & Package
- **Q & A / Next steps**



TOURNAMENT INFORMATION

Name: Pelican Women's Championship Presented by Dex Imaging

Event: Official LPGA Tournament

Format: Four-day, 72-hole stroke

Dates: May 11 – 17, 2020

Location: Belleair, FL

Host Course: Pelican Golf Club

Management Company: Eiger Marketing Group

Television: The Golf Channel (10+ hours)

Purse: \$1,750,000

Attendance: 50,000+

Economic Impact: \$15 million +



THE LPGA TOUR

- The Ladies Professional Golf Association (LPGA) is one of the longest-running women's professional sports associations in the world
- Championing opportunities for women to become leaders and role models to make the next generation even better
- Maintains a strong focus on charity through its tournaments with a cumulative charitable contribution of over \$200 million
- The LPGA Tour features the most talented, global group of professionals
- Visible commitment to diversity, inclusion, individuality and authenticity
- The LPGA Tour hosts 34 events in 15 different countries
- Of the more than 530 LPGA Tour members, approximately 220 are active competitors, of which 125 are international members representing 32 different countries.



2020 TOURNAMENT SCHEDULE

Monday (Closed to public)

- Practice rounds
- LPGA qualifier (Location: TBD)

Tuesday (Closed to public)

- Practice Rounds
- Women's Leadership Summit
- Pro-Am Pairings Party

Wednesday

- Official Pro-Am
- Pro-Am Reception

Thursday

- First round
- Live Golf Channel Coverage

Friday

- Second round
- Live Golf Channel Coverage
- Cut to Low 70 & ties

Saturday

- Third round
- Live Golf Channel Coverage
- Junior Golf Show

Sunday

- Final Round
- Live Golf Channel Coverage
- 18th Green Award Ceremony



ShopRite LPGA Classic Presented by Acer

FINAL RD	TOTAL	71	TODAY	
1	THOMPSON	-11	11	-3
	J. LEE6	-11	9	-1
3	McDONALD	-9	10	-1
	STACKHOUSE	-9	9	E
5	NORDQVIST	-8	13	-3
6	A. JUTANUGARN	-6	68	-3
	CREAMER	-6	14	-1

LIVE GOLF



CME GROUP TOUR CHAMPIONSHIP
1st ROUND GROUPING - TEE TIME: 10:41AM ET (1st TEE)

ARIYA JUTANUGARN LYDIA KO BROOKE HENDERSON

COVERAGE BEGINS THURSDAY - 4:30PM ET ON GOLF CHANNEL

OPERATIONS



SITE PLAN – COURSE MAP



PELICAN GOLF CLUB

PROPOSED GOLF SCORECARD

Hole	Par	Length (Yards)
1	4	328
2	4	484
3	3	198
4	4	461
5	4	360
6	4	369
7	5	542
8	4	445
9	3	158
Out	35	3,345
10	4	512
11	4	381
12	3	178
13	4	483
14	5	529
15	3	221
16	4	425
17	4	378
18	4	481
In	35	3,588
Total	70	6,933

LEGEND

- Main Entrance
- Volunteer HQ
- Merchandise
- Concessions
- Restroom
- ATM
- Tito's Corral
- Bleachers
- First Aid
- Handicap Access
- McGettigan's 19th Hole
- Aon Risk-Reward Hole
- Putting Green
- Driving Range
- Expo Village
- Oreo Family Fun Zone
- ShopRite Suite
- Champions Club
- Seaview Suite
- Kimberly-Clark Suite
- Borgata Skybox on 17
- ShopRite Pavilion
- Patriots' Pavilion presented by Kleenex and SERVPRO



HOLES	1	2	3	4	5	6	7	8	9	OUT	10	11	12	13	14	15	16	17	18	IN	TOTAL
YARDS	351	421	465	381	301	396	193	323	477	3308	352	184	315	409	419	198	379	119	507	2822	6190
PAR	4	4	5	4	4	4	3	4	5	37	4	3	4	4	4	3	4	3	5	34	71

EXAMPLE FINAL COURSE MAP

SITE PLAN – TOURNAMENT ENTRANCE



SITE PLAN – TOURNAMENT ENTRANCE



SITE PLAN – 18TH GREEN HOSPITALITY

DRAFT – AS OF 11.01.2019

- A. (1) 40' X 22' TROPHY SUITE
- B. (1) 48' X 26' TROPHY SUITE
- C. (2) 24' X 26' TROPHY SUITES
- D. (4) 16' X 26' TROPHY SUITES

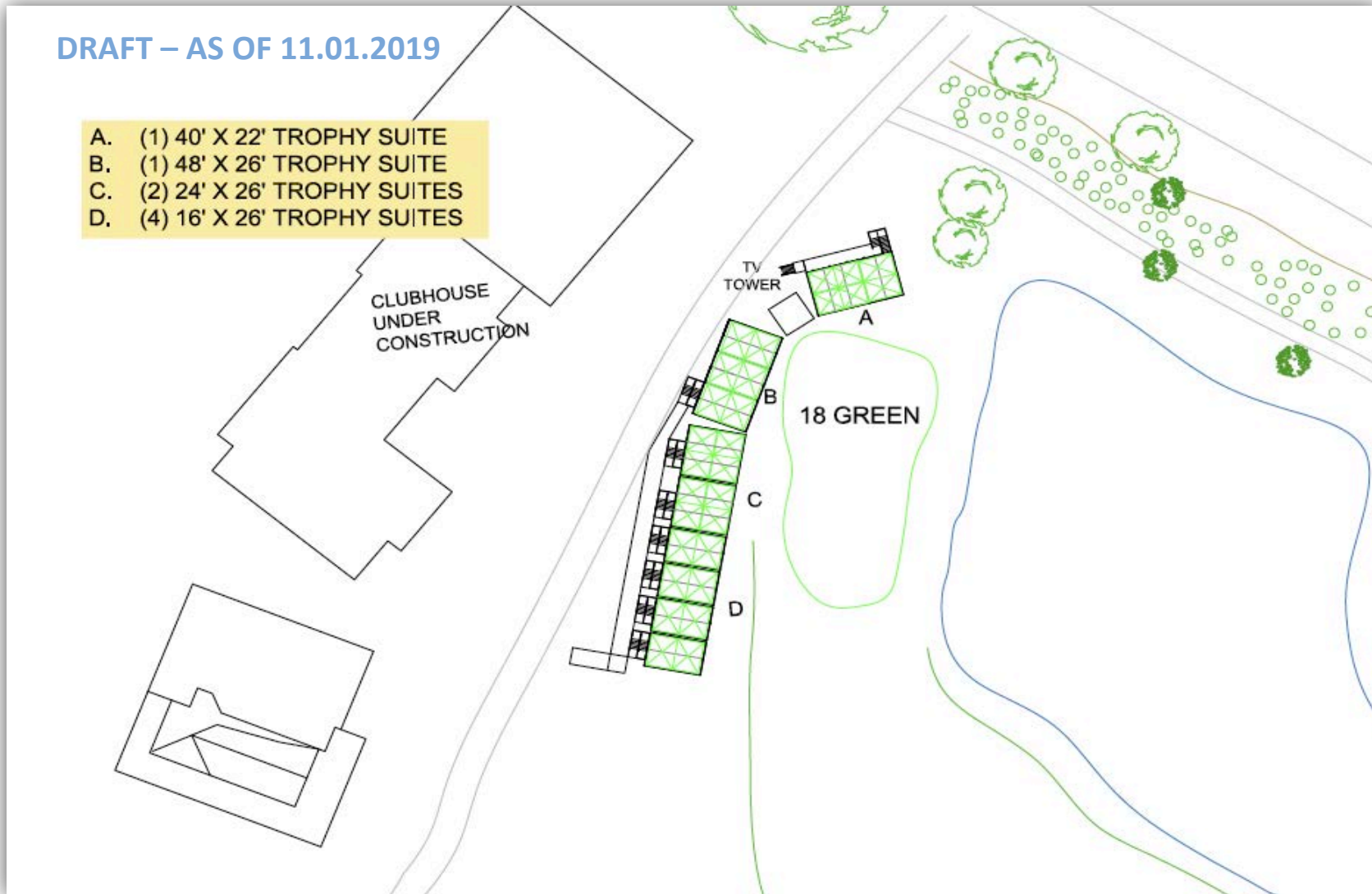

SITE PLAN – 18TH GREEN HOSPITALITY

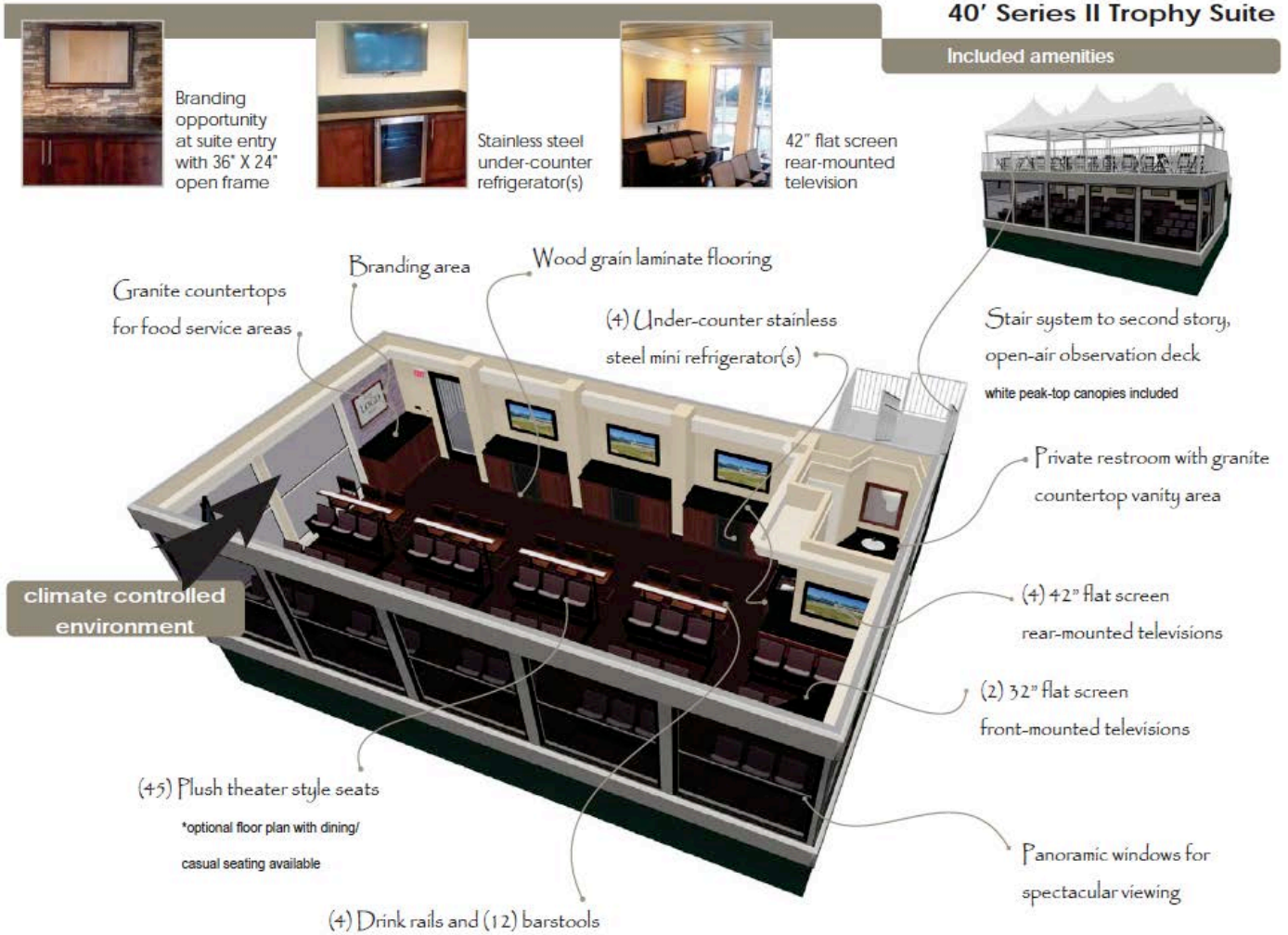

SITE PLAN – 18TH GREEN HOSPITALITY



40' SERIES II TROPHY SUITE

***Suite capacity dependent upon seating configurations**

Capacity limits are subject to approval by the building and safety authority governing the Suite installation location.

INTERIOR
CAPACITY: 51*

DINING STYLE OBSERVATION DECK
CAPACITY: 50*

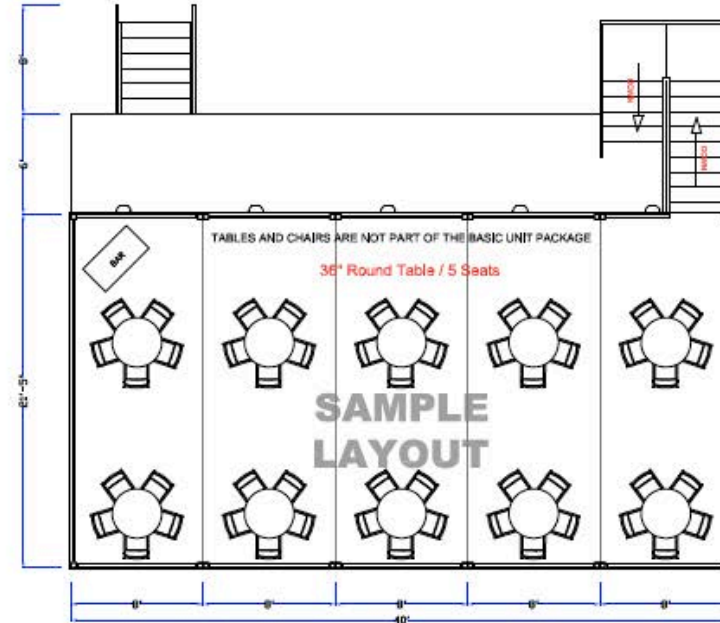
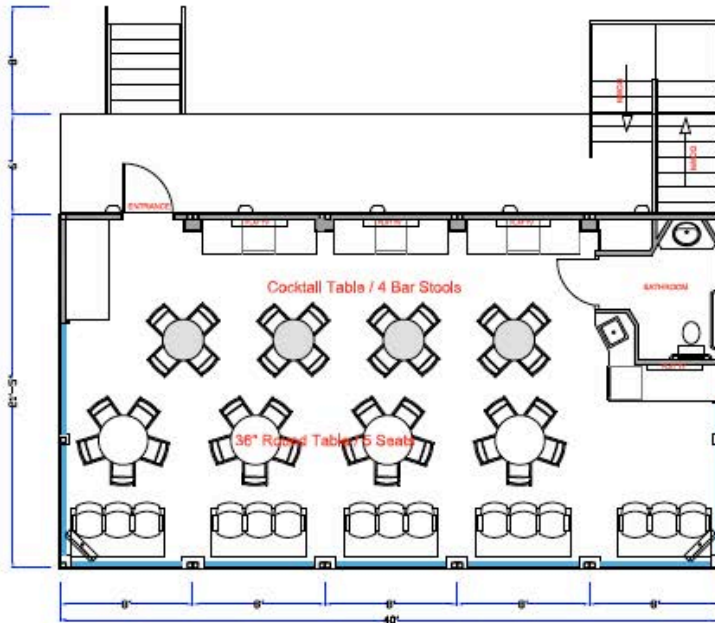

CONSTRUCTION SCHEDULE



April 2020

Sun	Mon	Tue	Wed	Thr	Fri	Sat
			1	2	3	4
5	6	7	8	9	10	11
12	13	14	15	16	17	18
19	20	21	22	23	24	25
26	27	28	29	30		

PRE-ADVANCE WEEK

May 2020

Sun	Mon	Tue	Wed	Thr	Fri	Sat
					1	2
3	4	5	6	7	8	9
		ADVANCE WEEK				
10	11	12	13	14	15	16
		TOURNAMENT WEEK				
17	18	19	20	21	22	23
		BREAKDOWN				
24	25	26	27	28	29	30
31						

PARKING



Note: Ideal general spectator parking location would be located within 15 minutes of the golf course and hold 700-1000 parking spaces.

Name	Address	Spaces	Function	Contact
Largo Central Park	101 Central Park Dr Largo, FL 33771	300+	General Spectators	Need assist
Clearwater Ferry/ Library/ Town Hall	100 Drew St Clearwater, FL 33756	300+	General Spectators	In contact/ Need assist
Morton Plant	300 Pinellas St Clearwater, FL 33756	N/A	Volunteers/ Support	In contact
First Assembly Clearwater / Charter	1739 S Martin Luther King Jr Ave Clearwater, FL 33756	200+	Volunteers/ Support	In contact/ Need assist with Charter
Belleair Parks and Rec	918 Osceola Rd Belleair, FL 33756	20+	VIP/ Media	Need assist
Largo High School	410 Missouri Ave N Largo, FL 33770	200+	TBD	Need assist
Taylor Park	1100 8th Ave SW Largo, FL 33770	100+	TBD	Need assist

Misc. Vendors

ECOLOGY

- Preferred vendor: Solo Events Group (management), Waste Management (bins)
- Team of 4-6 ecology staff that install, maintain, and breakdown temporary trash and recycling services onsite
- WM to service bins as needed throughout the week

SANITARY STATIONS

- TBD number of portable restrooms and restroom trailers to supplement VIP Hospitality
- Serviced post competition daily (approx. 6-8pm)
- Best-effort to be placed in centrally located hubs inside of the golf course near F&B and/ or public viewing



TEMPORARY POWER

- Preferred vendor: Special Event Service Rental (SESR)
- Team of 1-2 event electricians to order, install, and connect all temporary power and HVAC needs onsite
- Majority quiet generators (due to golf), turned on each morning and shut down each night

VOLUNTEERS



MORE THAN JUST GOLF

Volunteers are crucial to the success of the Pelican Women's Championship. These opportunities will help us host a world-class women's professional golf event.

Why Volunteer?

- Be a part of the inaugural Pelican Women's Championship
- Support an event that helps our economy and community
- Build lasting friendships and memorable experiences
- Boost your resume with community volunteer experience



REQUIREMENTS

- Minimum of 3 shifts (4-6 hours)
- 18 years or older unless a legal guardian signs the volunteer application waiver
 - 13 years or younger must volunteer with a parent or legal guardian
- All volunteers must attend Volunteer Training before working their first shift



COMMITTEES

With 10+ committees, there is a wide variety of options for volunteers to choose from. Some of our most popular committees include:

- Marshals
- Standard Bearers
- Walking Scorers
- Transportation
- Hospitality
- And more....

Please see the handout for more details!



VOLUNTEER PACKAGE

Package Includes:

- 1 Official Pelican Women's Championship polo
 - 1 Hat or Visor
 - Inaugural Tournament Pin
 - Volunteer Badge
 - 2 Good Any One Day Grounds Tickets
 - 1 Parking Pass
 - 1 Invitation to the Volunteer Appreciation Party
-
- \$55 until March 31st
 - \$65 April 1st on

Volunteering also comes with:

Volunteer Golf Outing at the Pelican Golf Club



CONTACT INFORMATION



Kyle Draper
VP Partnerships
e: kdraper@eigermarketing.com
o: 727.977.5182
c: 813.352.9112

Sam Mok
Tournament Services Manager
e: smok@eigermarketing.com
o: 727.977.5183
c: 609.613.2350

Jon Show
Marketing & PR Director
e: media@eigermarketing.com

Ryan Dever
Tournament Manager
e: rdever@eigermarketing.com
o: 609.957.5599
c: 856.816.3573

Nathalie Filler
Tournament Coordinator
e: nfiller@eigermarketing.com
o: 727.977.5184
c: 860.707.2139





THANK YOU

