

BELLEAIR TOWN HALL
901 Ponce de Leon Boulevard
Belleair, Florida 33756

Phone: (727) 588-3769

www.townofbelleair.com

APPLICATION FOR HISTORIC DESIGNATION

1. NAME AND LOCATION OF PROPERTY

Historic Name: _____

FL Master Site File Form Number (if applicable): _____

Address: 360 WOODLAWN AVE

Historic Address (if applicable): _____

2. PROPERTY OWNER(S) NAME AND ADDRESS

Name: NICHOLAS MIDDLETON

Address: 360 WOODLAWN AVE

City/Town: BELLEAIR State: FL Zip Code: 33756

Primary Phone: 813 892 9310 Secondary Phone: _____

Email: INEVERUSETHIS08@GMAIL.COM

3. NOMINATION PREPARED BY

Name/Title: RECEIVED LETTER IN THE MAIL

Organization: _____

Address: _____

City/Town: _____ State: _____ Zip Code: _____

Primary Phone: _____ Secondary Phone: _____

Email: _____

Date Prepared: 6/3/21 Signature: 

4. BOUNDARY DESCRIPTION AND JUSTIFICATION

Describe all boundary lines encompassing all man-made and natural resources to be included in the designation (general legal description or survey). Attach a map delimiting proposed boundary (use continuation sheet if necessary).

5. GEOGRAPHIC DATA

Acreage of Property: _____

Property Identification Number: _____

6. FUNCTION OR USE

Historic Functions

Current Functions

_____	_____
_____	_____
_____	_____

7. DESCRIPTION

Architectural Classification

Materials

_____	_____
_____	_____
_____	_____
_____	_____

Narrative Description *Describe the historic and existing condition of the property use conveying the following information: original location and setting, natural features, pre-historic man-made features, subdivision design, description of surrounding buildings, major alterations and present appearance, and interior appearance. One or more continuation sheets may be used for this section.*

Narrative Description Continued

8. NUMBER OF RESOURCES WITHIN PROPERTY

Contributing resources previously listed on the National Register or Local Register:

<u>Resource Type</u>	<u># of Contributing</u>	<u># of Noncontributing</u>
Buildings	_____	_____
Structures	_____	_____
Sites	_____	_____
Objects	_____	_____
<u>Total</u>	_____	_____

9. STATEMENT(S) OF SIGNIFICACE (PER CODE SEC. 74-332.)

Mark one or more boxes for the appropriate criteria.

a. Its character, interest or value as part of the development, heritage, or cultural characteristics of the town, county, state or nation.

Areas of Significance: _____

b. Its location as a site of significant local, county, state or national event.

c. Its identification with a person or persons who significantly contributed to the development of the town, county, state or nation.

Person(s) of Significance: _____

d. Its embodiment of distinguishing characteristics of an architectural style valuable for the study of a period, type, method of construction or use of indigenous materials.

Architectural Style: _____

e. Its identification as the work of a master builder, craftsman, designer, engineer, architect, landscape architect or planner whose individual work has influenced the development of the town, county, state or nation.

Person(s) of Significance: _____

f. Its embodiment of elements of design, detailing, materials, or craftsmanship that render it architecturally significant.

g. Its embodiment of design elements that make it structurally or architecturally innovative.

h. Its unique location or singular physical characteristics that make it an established or familiar visual feature.

i. Its suitability for preservation or restoration.

(j. Where the interior of a building or structure is designated, the designation shall include a finding designating the specific portions of the interior that make it suitable for designation and a finding that the interior is accessible to the public as a common area in the normal course of the building's use.

Narrative Statement of Significance *Explain the significance of the property as it relates to the above criteria and information on one or more continuation sheets. Include biographical data on significant person(s), builder and architect, if known. One or more continuation sheets may be used for this section.*

10. MAJOR BIBLIOGRAPHICAL REFERENCES

Cite the books, articles, and other sources used in preparing this form, use continuation sheets if needed.

11. REQUEST FOR REMOVAL FROM LIST OF HISTORIC STRUCTURES

If applicable, cite reasons for removal from list of historic structures.

12. CONTINUATION SECTION

Original
 Update



HISTORICAL STRUCTURE FORM

FLORIDA MASTER SITE FILE

Version 4.0 1/07

Site #8 **PI12894**
Field Date 6-4-2018
Form Date _____
Recorder # _____

Shaded Fields represent the minimum acceptable level of documentation.
Consult the *Guide to Historical Structure Forms* for detailed instructions.

Site Name(s) (address if none) 360 Woodlawn Avenue Multiple Listing (DHR only) _____
Survey Project Name Town of Belleair Historic Resources Survey Survey # (DHR only) _____
National Register Category (please check one) building structure district site object
Ownership: private-profit private-nonprofit private-individual private-nonspecific city county state federal Native American foreign unknown

LOCATION & MAPPING

Address: 360 Woodlawn Avenue
Cross Streets (nearest / between) _____
USGS 7.5 Map Name CLEARWATER USGS Date 1977 Plat or Other Map _____
City / Town (within 3 miles) Belleair In City Limits? yes no unknown County Pinellas
Township 29S Range 15E Section 21 ¼ section: NW SW SE NE Irregular-name: _____
Tax Parcel # 21-29-15-08640-000-0790 Landgrant _____
Subdivision Name BIDWELL'S WILDWOOD PARK Block _____ Lot 79 & 78
UTM Coordinates: Zone 16 17 Easting 322670 Northing 3092179
Other Coordinates: X: _____ Y: _____ Coordinate System & Datum _____
Name of Public Tract (e.g., park) _____

HISTORY

Construction Year: 1926 approximately year listed or earlier year listed or later
Original Use Private Residence (House/Cottage/Cabin) From (year): 1926 To (year): _____
Current Use _____ From (year): _____ To (year): _____
Other Use _____ From (year): _____ To (year): _____
Moves: yes no unknown Date: _____ Original address _____
Alterations: yes no unknown Date: _____ Nature porch, windows, siding
Additions: yes no unknown Date: _____ Nature _____
Architect (last name first): Unknown Builder (last name first): Unknown
Ownership History (especially original owner, dates, profession, etc.) Unknown

Is the Resource Affected by a Local Preservation Ordinance? yes no unknown Describe HP Ordinance # 429

DESCRIPTION

Style Bungalow Exterior Plan L-shaped Number of Stories 1
Exterior Fabric(s) 1. Stucco 2. Aluminum 3. _____
Roof Type(s) 1. Clipped gable 2. _____ 3. _____
Roof Material(s) 1. Asphalt shingles 2. _____ 3. _____
Roof secondary strucs. (dormers etc.) 1. _____ 2. _____
Windows (types, materials, etc.) 1/1 double hung replacement windows (vinyl/aluminum)

Distinguishing Architectural Features (exterior or interior ornaments) Clipped gable roof, half-timber detailing applied on gable ends.

Ancillary Features / Outbuildings (record outbuildings, major landscape features; use continuation sheet if needed.) Carport connected to house by walkway.

DHR USE ONLY		OFFICIAL EVALUATION	DHR USE ONLY	
NR List Date	SHPO – Appears to meet criteria for NR listing: <input type="checkbox"/> yes <input type="checkbox"/> no <input type="checkbox"/> insufficient info	Date _____	Init. _____	
<input type="checkbox"/> Owner Objection	KEEPER – Determined eligible: <input type="checkbox"/> yes <input type="checkbox"/> no	Date _____		
	NR Criteria for Evaluation: <input type="checkbox"/> a <input type="checkbox"/> b <input type="checkbox"/> c <input type="checkbox"/> d (see <i>National Register Bulletin 15</i> , p. 2)			

DESCRIPTION (continued)

Chimney: No. 0 Chimney Material(s): 1. 2.
Structural System(s): 1. Unknown 2. 3.
Foundation Type(s): 1. 2.
Foundation Material(s): 1. 2.
Main Entrance (stylistic details) Located within screened-in porch.

Porch Descriptions (types, locations, roof types, etc.) Porch has been screened in and enclosed.

Condition (overall resource condition): [] excellent [x] good [] fair [] deteriorated [] ruinous

Narrative Description of Resource One-story bungalow dwelling with L-shaped plan is capped by a clipped gable roof of asphalt shingles. Alterations to the property include enclosure of front porch, replacement window & siding, and the addition of a walkway connecting the carport to house

Archaeological Remains Unknown [] Check if Archaeological Form Completed

RESEARCH METHODS (check all that apply)

- [x] FMSF record search (sites/surveys) [] library research [] building permits [] Sanborn maps
[] FL State Archives/photo collection [] city directory [] occupant/owner interview [] plat maps
[x] property appraiser / tax records [x] newspaper files [] neighbor interview [] Public Lands Survey (DEP)
[] cultural resource survey (CRAS) [x] historic photos [] interior inspection [] HABS/HAER record search
[] other methods (describe)

Bibliographic References (give FMSF manuscript # if relevant, use continuation sheet if needed) County tax records; Belleair Architectural/Historic Inventory by Stevenson Architects (1997); Town records

OPINION OF RESOURCE SIGNIFICANCE

Appears to meet the criteria for National Register listing individually? [] yes [x] no [] insufficient information

Appears to meet the criteria for National Register listing as part of a district? [] yes [x] no [] insufficient information

Explanation of Evaluation (required, whether significant or not; use separate sheet if needed) This building is not eligible for listing on the NRHP under Criterion C due to additions & material alterations, which have greatly lessened the building's integrity. Additional research is necessary to determine eligibility under criteria A, B, or D.

Area(s) of Historical Significance (see National Register Bulletin 15, p. 8 for categories: e.g. "architecture", "ethnic heritage", "community planning & development", etc.)

- 1. Architecture 3. 5.
2. Community planning & development 4. 6.

DOCUMENTATION

Accessible Documentation Not Filed with the Site File - including field notes, analysis notes, photos, plans and other important documents

- 1) Document type Maintaining organization
Document description File or accession #'s
2) Document type Maintaining organization
Document description File or accession #'s

RECORDER INFORMATION

Recorder Name Sara McLaughlin Affiliation Johnson, Mirmiran & Thompson

Recorder Contact Information 1600 Market St., Ste. 520, Philadelphia PA, 19103; 267-256-4747; smclaughlin@jmt.com
(address / phone / fax / e-mail)

Required Attachments
1 USGS 7.5' MAP WITH STRUCTURE LOCATION PINPOINTED IN RED
2 LARGE SCALE STREET, PLAT OR PARCEL MAP (available from most property appraiser web sites)
3 PHOTO OF MAIN FACADE, ARCHIVAL B&W PRINT OR DIGITAL IMAGE FILE
If submitting an image file, it must be included on disk or CD AND in hard copy format (plain paper is acceptable). Digital image must be at least 1600 x 1200 pixels, 24-bit color, jpeg or tiff.

Wildwood Way

Wildwood Way

Wildwood Way

Wildwood Way

Orange Ave

Orange Ave

Woodlawn Ave

Woodlawn Ave

Woodlawn Ave

Woodlawn Ave



360 Woodlawn Ave,
Belleair, FL 33756
[3 min drive - home](#)

311

307

321

323

325

327

1400

1402

415

308

302

306

340

1465

1466

418

380

302

307

308

311

313

375

415

421

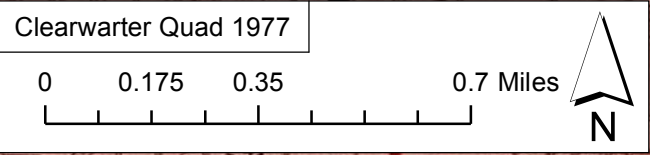
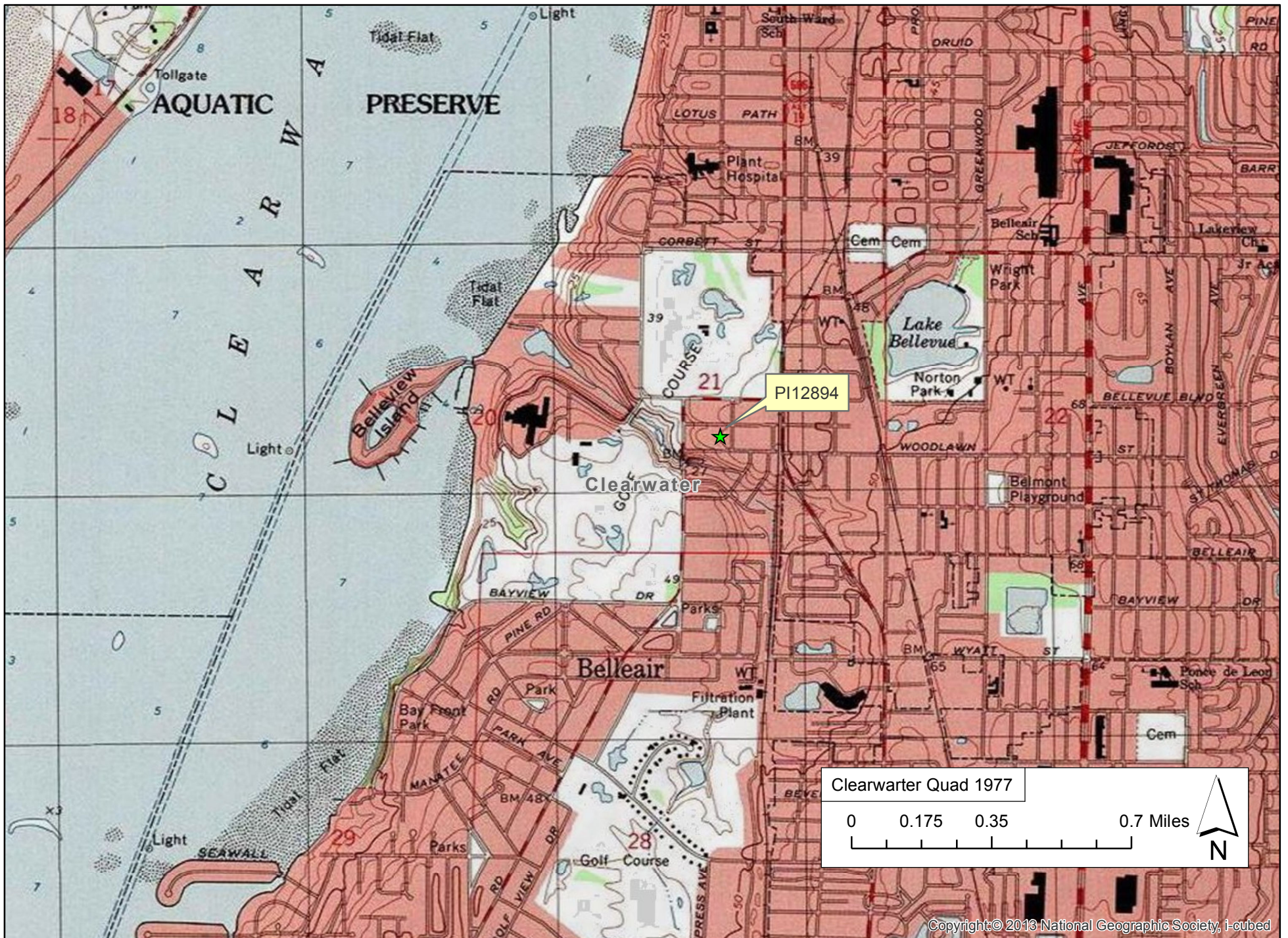

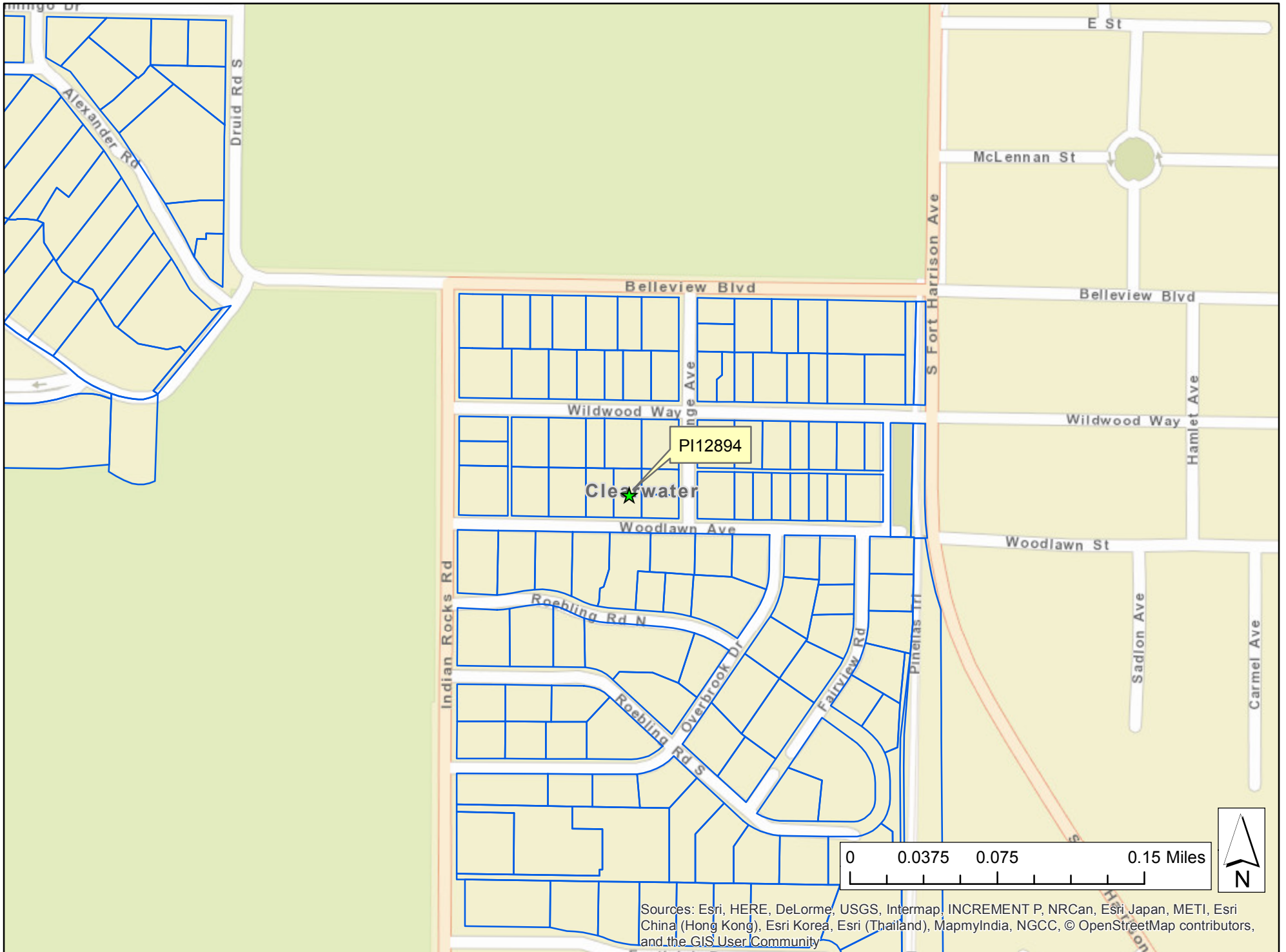

Sources: Esri, HERE, DeLorme, USGS, Intermap, INCREMENT P, NRCan, Esri Japan, METI, Esri China (Hong Kong), Esri Korea, Esri (Thailand), MapmyIndia, NGCC, © OpenStreetMap contributors, and the GIS User Community



