

File: R:\Projects\Harrod The Pelican\Plans\Pelican - Cottages; Plotted: 7/22/2019 4:59 PM by MICHAEL KNIGHT; Saved: 7/22/2019 4:56 PM by MICHAEL

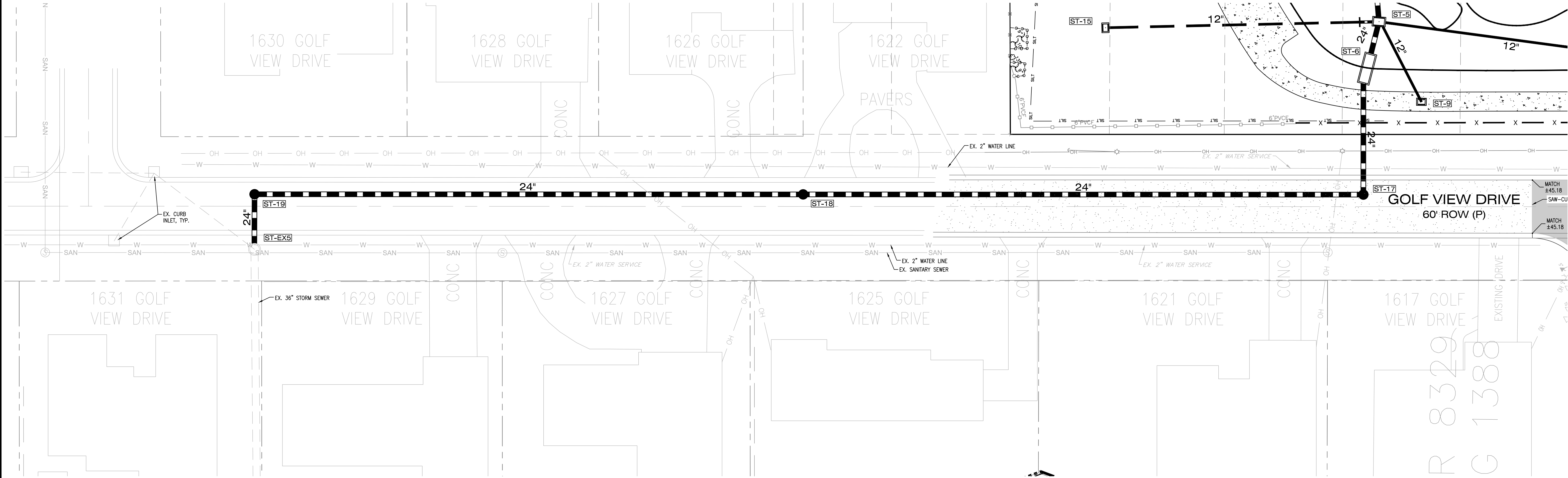

STORM STRUCTURES

ST-17 **
TYPE P MANHOLE
RIM EL 45.3
INV EL 40.4 (24") NE
INV EL 40.4 (24") SW

ST-18 **
TYPE P MANHOLE
RIM EL 44.85
INV EL 40.0 (24") NE
INV EL 40.0 (24") SW

ST-19 **
TYPE P MANHOLE
RIM EL 44.4
INV EL 39.7 (24") NE
INV EL 39.7 (24") SE

ST-EX5 **
EXISTING MANHOLE
RIM EL XX.X
INV EL XX.X (XX") SW
INV EL 39.5 (24") NW
INV EL 39.5 (36") SE

** STRUCTURE DATA
TO BE VERIFIED
AFTER SURVEY DATA
IS RECEIVED.

PELICAN GOLF CLUB - PHASE III & IV

"COTTAGES"

HARROD PROPERTIES, INC.
5550 WEST EXECUTIVE DRIVE - 550
TAMPA, FLORIDA 33609

AUTORA
CIVIL ENGINEERING, INC.
610 E. Morgan Street Brandon, FL 33510 (813) 843-9907

Professional Engineer
No. 3446
State of FL
Exp. 12/31/2021

Chris Weddle
Professional Engineer
No. 20089509
State of FL
Exp. 12/31/2021

OFFSITE UTILITY
AND STORM PLAN

NO.	BY	DATE	DESCRIPTION
1	CHS	7/22/2019	ISSUED FOR PERMIT
2	CHS	7/22/2019	REVISIONS
3	CHS	7/22/2019	REVISIONS
4	CHS	7/22/2019	REVISIONS
5	CHS	7/22/2019	REVISIONS
6	CHS	7/22/2019	REVISIONS
7	CHS	7/22/2019	REVISIONS
8	CHS	7/22/2019	REVISIONS
9	CHS	7/22/2019	REVISIONS
10	CHS	7/22/2019	REVISIONS
11	CHS	7/22/2019	REVISIONS
12	CHS	7/22/2019	REVISIONS
13	CHS	7/22/2019	REVISIONS
14	CHS	7/22/2019	REVISIONS
15	CHS	7/22/2019	REVISIONS
16	CHS	7/22/2019	REVISIONS
17	CHS	7/22/2019	REVISIONS
18	CHS	7/22/2019	REVISIONS
19	CHS	7/22/2019	REVISIONS
20	CHS	7/22/2019	REVISIONS

DESIGNED BY: EL KNIGHT
CHECKED BY: CHRIS WEDDLE
DATE: 7/22/2019
JOB NO.: 18-174